

Determining visibility at intersections: For complete details, see Municipal Code Section 32-22.2

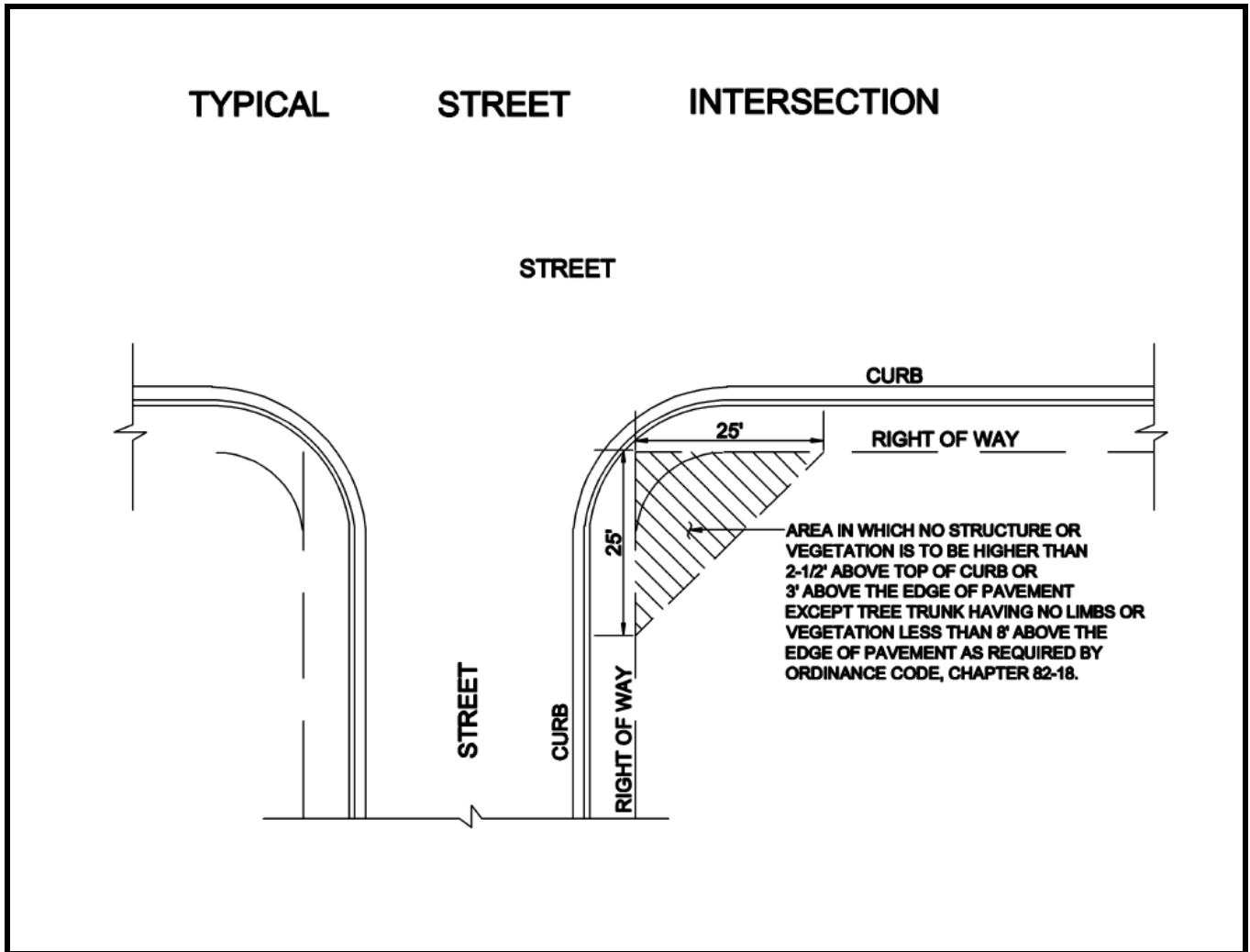

These graphics are for illustrative purposes only. For definitions and standards in its entirety, see Section 32-22 of the Danville Municipal Code, available at the Town's permit counter at 510 La Gonda Way or online at www.danville.ca.gov

Accessory Structures: For complete details, see Municipal Code Section 32-22.10

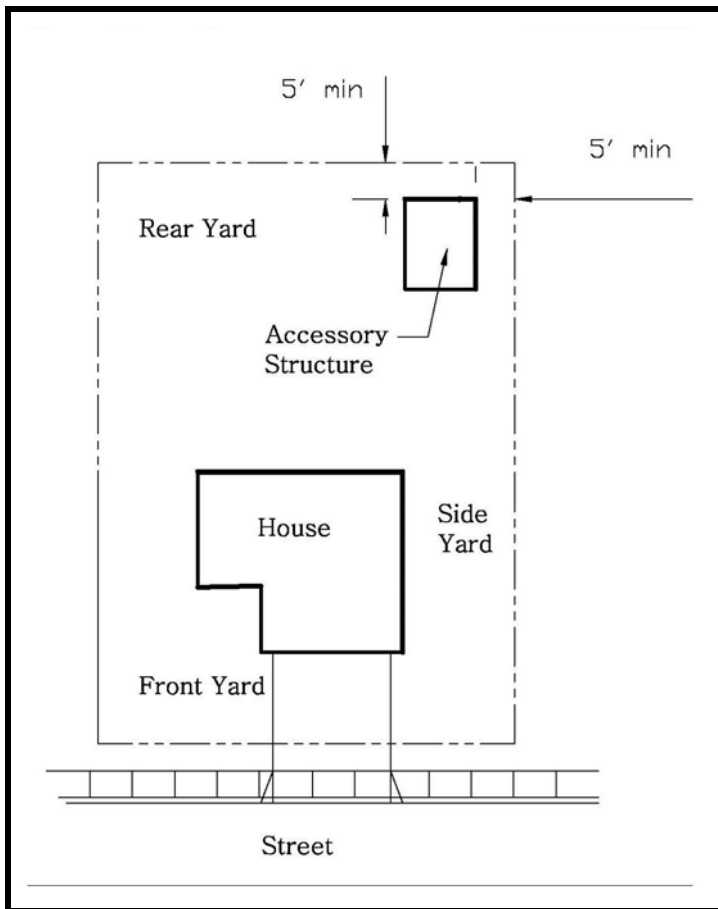
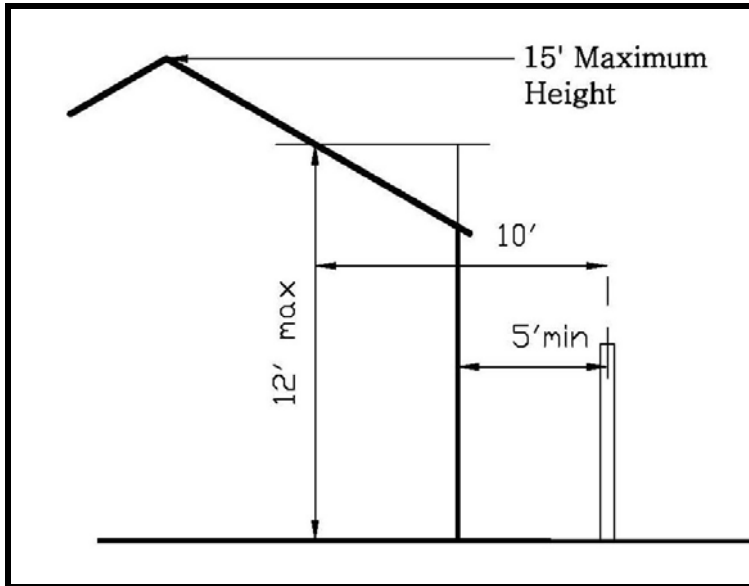

These graphics are for illustrative purposes only. For definitions and standards in its entirety, see Section 32-22 of the Danville Municipal Code, available at the Town's permit counter at 510 La Gonda Way or online at www.danville.ca.gov

Fences and retaining walls: For complete detail, see Municipal Code Section 32-22.11

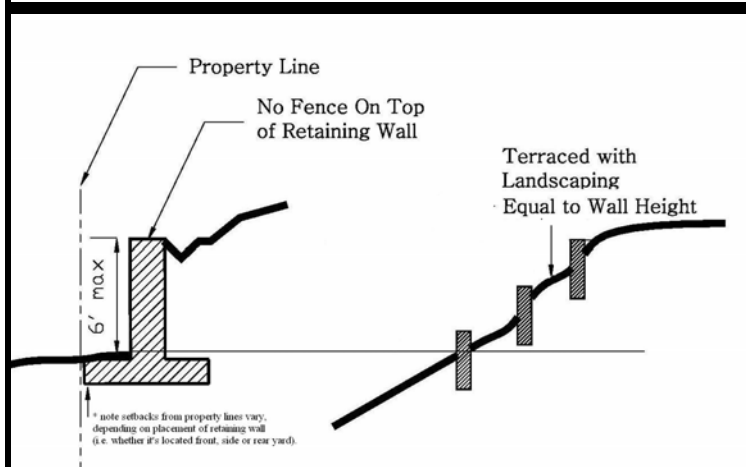
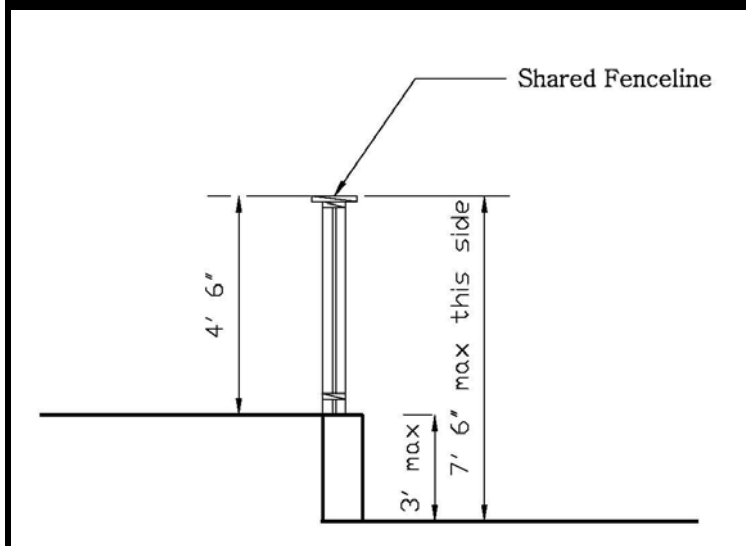
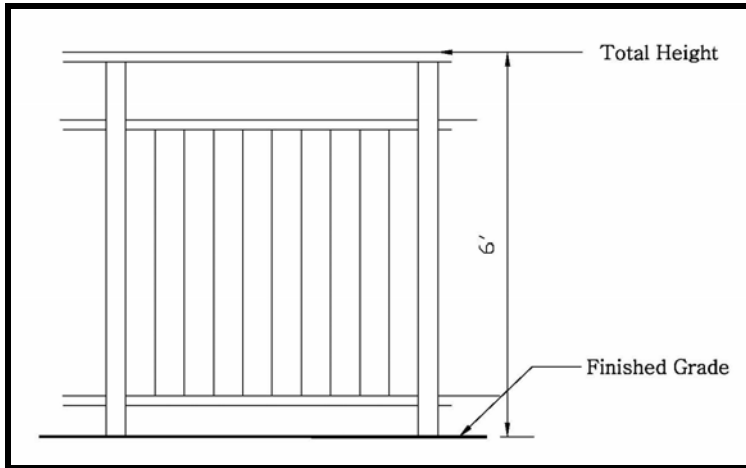

These graphics are for illustrative purposes only. For definitions and standards in its entirety, see Section 32-22 of the Danville Municipal Code, available at the Town's permit counter at 510 La Gonda Way or online at www.danville.ca.gov

Side loaded garages

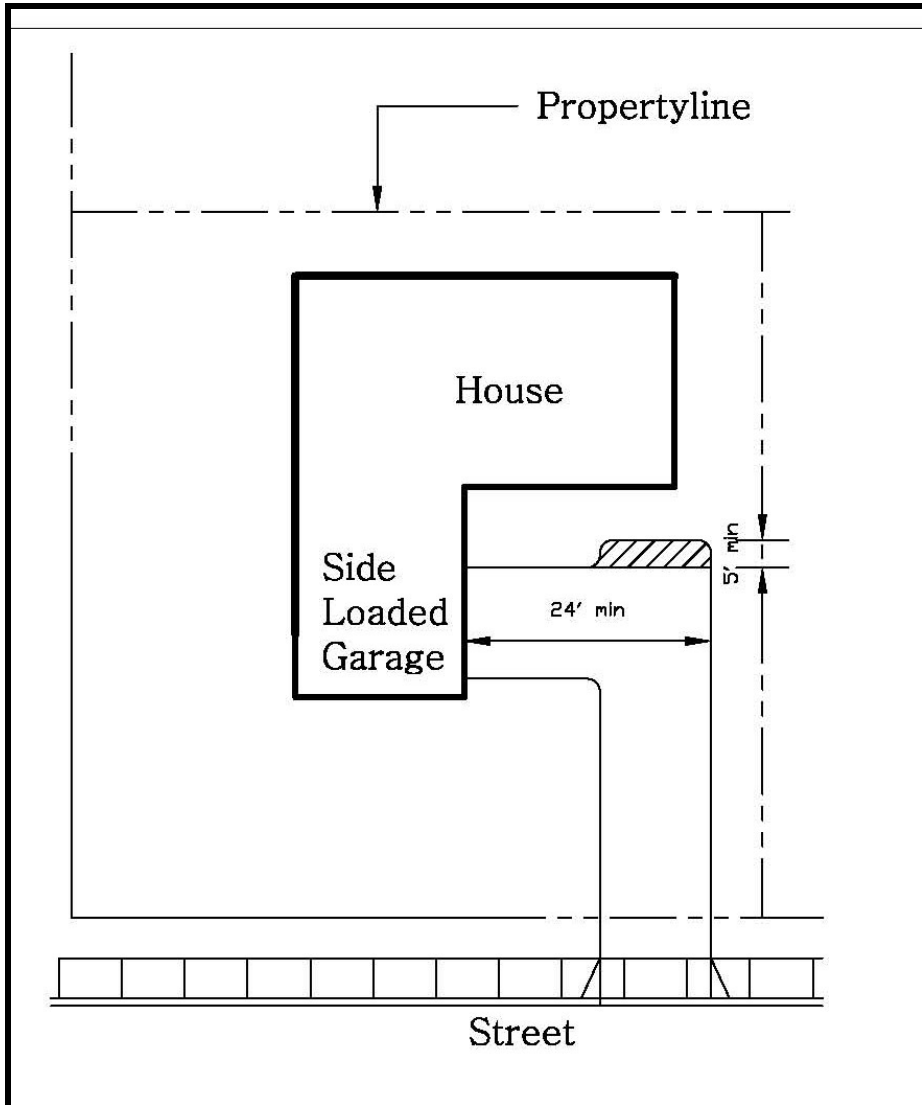

These graphics are for illustrative purposes only. For definitions and standards in its entirety, see Section 32-22 of the Danville Municipal Code, available at the Town's permit counter at 510 La Gonda Way or online at www.danville.ca.gov